



Geelong, VIC
164 Moorabool Street

- Large excellent CBD location
- Building area: 332m2 (approx)
- Rear lane access & loading
- Superb exposure
- Quality window display opportunity
- Staff amenities
- Zoned: Activity Centre Zone 1
- Available now

GARTLAND
PROPERTY

LEASED

Contact: Adam Boyce
0413 993 296

Type: Retail

<https://www.gartland.com.au>

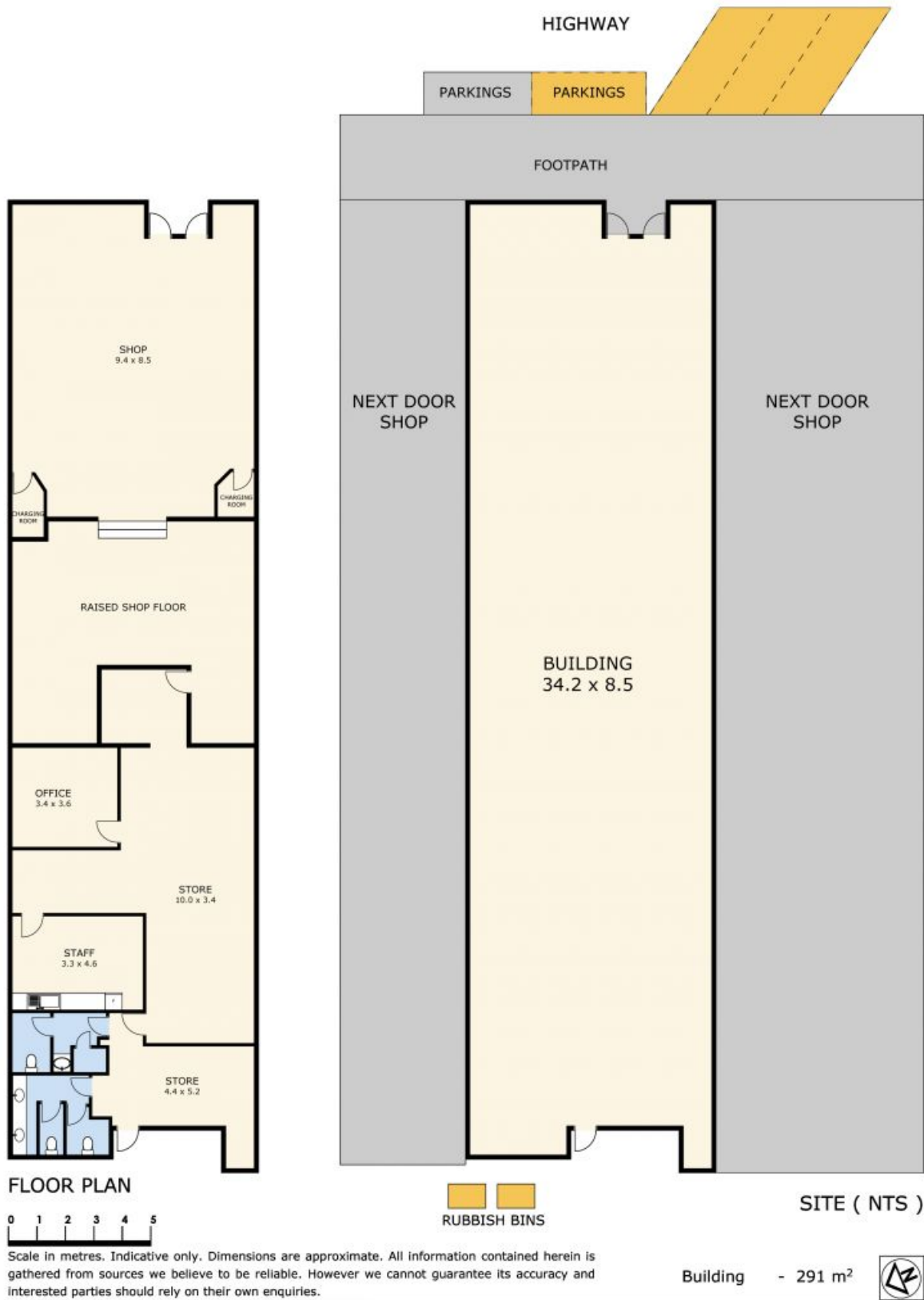

164 Moorabool Street, Geelong

Plans shown are only indicative of layout. Dimensions are approximate.

Geelong, VIC
164 Moorabool Street