



## Herne Hill, VIC

Shop 1/219B Church Street

**GARTLAND**  
PROPERTY

This retail shop is located on Church Street, Herne Hill but is part of the busy Minerva Road shopping precinct. Existing fit out includes reception area, office & tearoom. Surrounded by three schools, it has great passing traffic.

### LEASED

**Contact:** Adam Boyce  
0413 993 296

**Type:** Retail  
<https://www.gartland.com.au>

- \* \$13,000pa + GST + outgoings
- \* Floor area: 50m<sup>2</sup> approx
- \* Reception, office and tearoom area
- \* High exposure on Church Street
- \* Shared toilet facilities
- \* One rear car park
- \* Available now
- \* Zoned: Commercial 1

# 1/219B Church Street Herne Hill

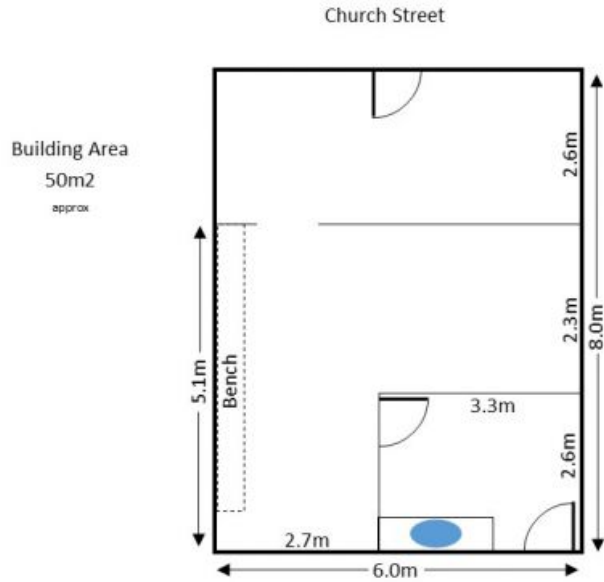

Plan is not to scale  
Measurements are approximate only

Plans shown are only indicative of layout. Dimensions are approximate.

**Herne Hill, VIC**  
Shop 1/219B Church Street