



Moolap, VIC

13 Nobility Street

GARTLAND
PROPERTY

This industrial shed is located in Moolap and has a good amount of land surrounding the shed.

- * Building area: 300m2 approx
- * Land area: 1011m2 approx
- * Shared entrance with secured fence
- * Colourbond construction
- * 3 Phase power
- * Front roller door (5m x 3.5m) & sliding door to side (4m x 4m)
- * Good office space
- * Shared toilet block
- * Minimum height: 4.8m & Maximum height: 5.7m
- * Zoned: Industrial 1

LEASED

Contact: Adam Boyce
0413 993 296

Type: Industrial

<https://www.gartland.com.au>

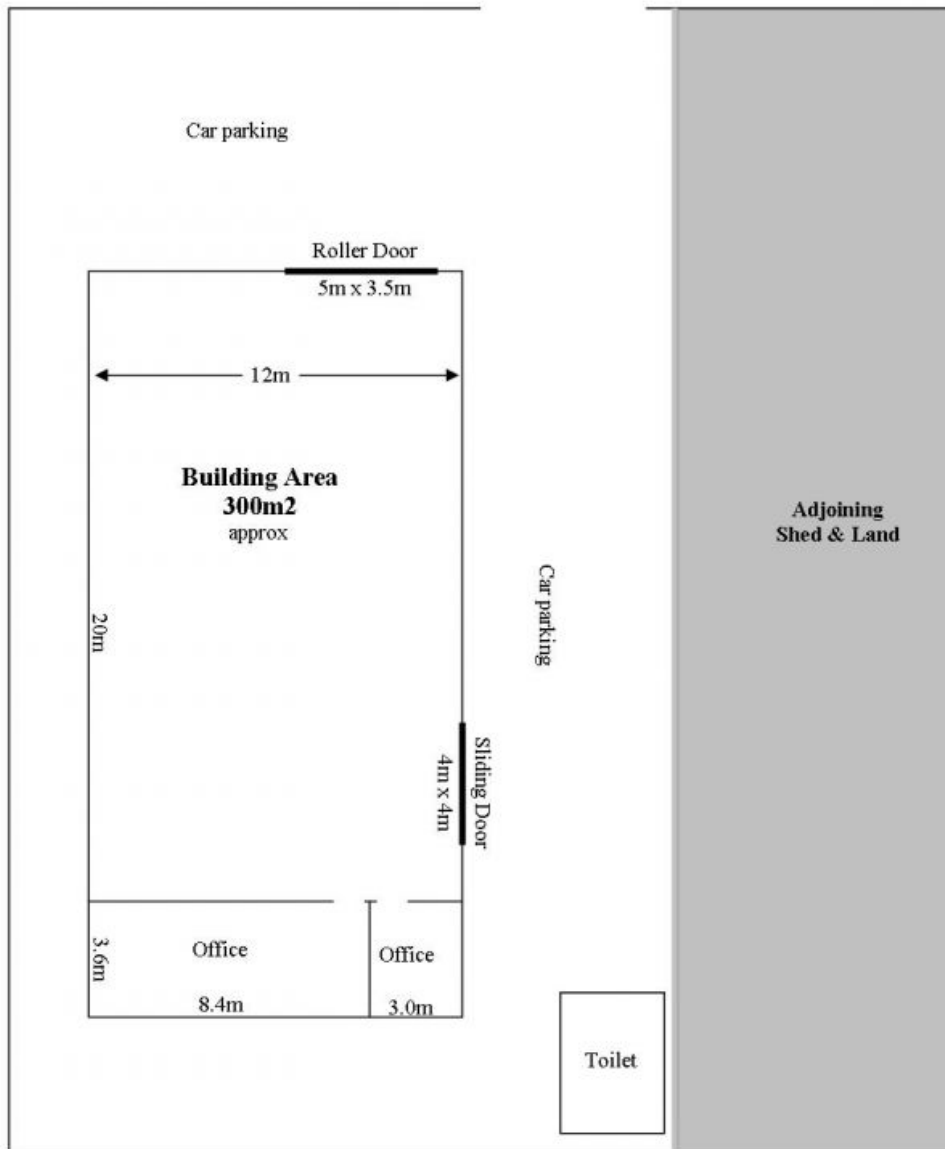

13 Nobility Street Moolap

Floor plan is not to scale
Measurements are approximate only

Plans shown are only indicative of layout. Dimensions are approximate.

Moolap, VIC
13 Nobility Street