



Geelong, VIC

100 Moorabool Street

This modern space is located in Moorabool Street, close to Geelong's major shopping centres and quality businesses, and could be used as retail or office.

- Building area: 194m2 approx
 - Metres from Market Square & Westfield Shopping Centres
 - Close to major banks
 - Surround by quality tenants including Charles Rose & Thomas Jewellers
 - Great window exposure
 - Rear lane access for deliveries
 - Excellent amenities
- * Zoned: 'Activity Centre 1'

GARTLAND
PROPERTY

LEASED

Contact: Adam Farrell
0439 309 928

Type: Retail
<https://www.gartland.com.au>

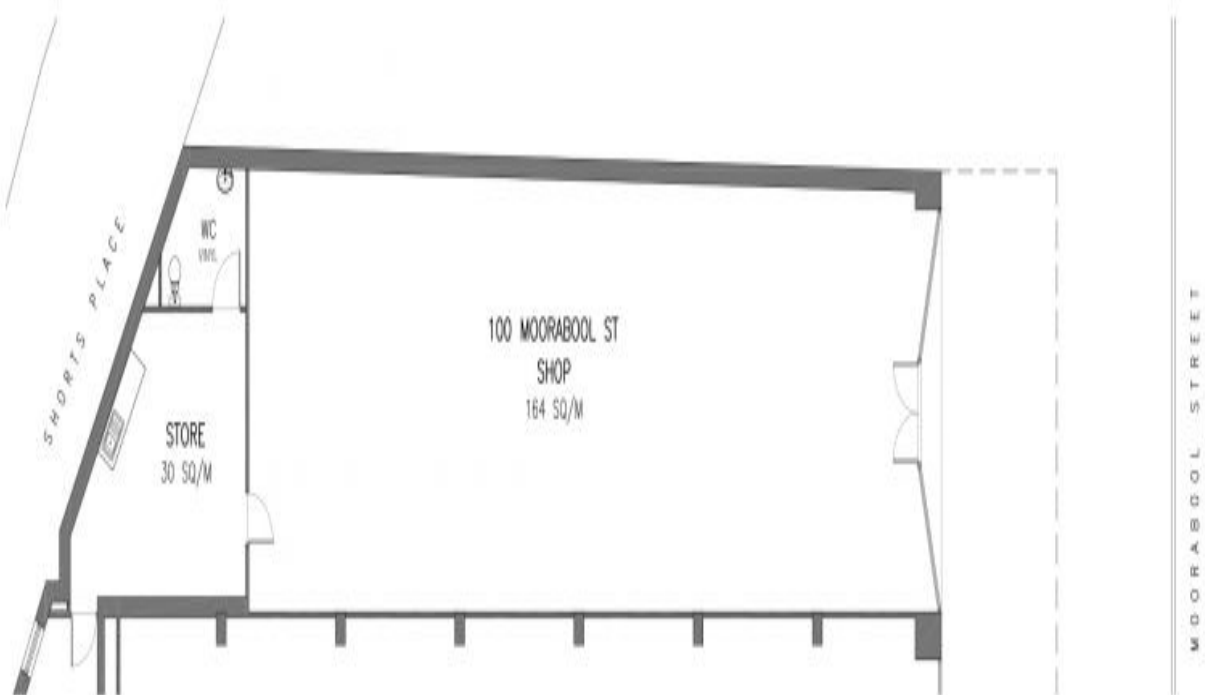

Plans shown are only indicative of layout. Dimensions are approximate.

Geelong, VIC
100 Moorabool Street