



## Belmont, VIC

23B Lloyd Street

**3**  
BED

**2**  
BATH

**GARTLAND**  
PROPERTY

This thoughtfully designed 3-bedroom townhouse will exceed all expectations. Located within 250 metres of the High Street shopping precinct, library and medical facilities; you can leave the car at home. This carefully planned home boasts 3 bedrooms, with a WIR and ensuite to the master; the remaining 2 bedrooms are generous in size and offer BIRs; the open plan kitchen, living, dining area is exceptionally spacious and offers superb functionality. The kitchen creates the perfect hub overlooking the dining/meals area with direct access to the rear deck; and lounge area ensuring an all-inclusive environment. The home has been well appointed, the kitchen boasts stone benches, a 900mm cook top and oven, dishwasher, and walk-in pantry. The property features 3 split systems, gas ducted heating, double glazed windows, a double garage with internal access, beautiful landscaped surrounds, designed for a low maintenance lifestyle, all in a private and secure location. Lloyd Street is perfectly positioned with ease of access to public transport and shopping facilities; is moments from the Surf

**SOLD**

**Contact:** Nathan Ashton  
0418 566 708

**Type:** House

**Sold Date:** 10/05/2019

**<https://www.gartland.com.au>**

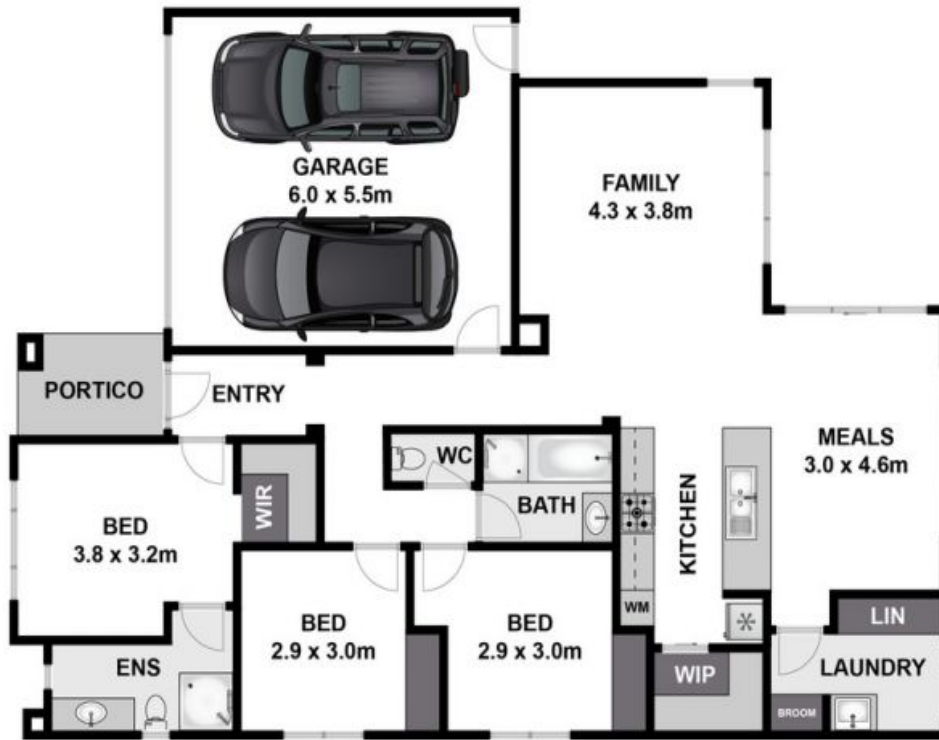

GROUND FLOOR

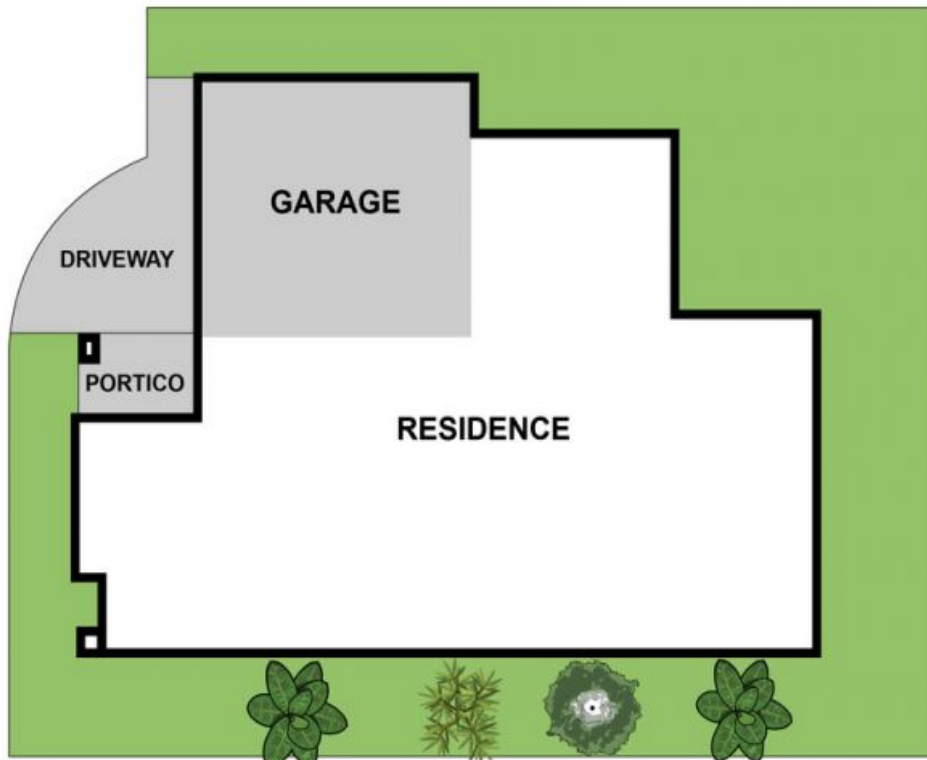

SITE PLAN

Approx House Area 169m<sup>2</sup>

Whilst [beerm.com.au](http://beerm.com.au) has made every attempt to ensure the accuracy of the floor plan contained here, measurements are approximate and no responsibility is taken for any error, omission, or mis-statement. This plan is for illustrative purposes only.

**23B Lloyd Street, Belmont**

**GARTLAND**  
PROPERTY

Plans shown are only indicative of layout. Dimensions are approximate.

**Belmont, VIC**  
23B Lloyd Street

