



North Geelong, VIC
25 Cowie Street

GARTLAND
PROPERTY

This superb Workshop/shed with Showroom and Office is situated on the southern side of Cowie Street and its proximity to major arterial roads including the Princess Hwy back to Melbourne and is only 8 kilometres from Geelong CBD is an added bonus. The property is surrounded by an array of quality businesses and future Industrial developments. The site is a regular shaped allotment and is level throughout and with a street frontage of over 30 metres its ideal for showcasing your business.

SOLD
Contact: Adam Farrell
 0439 309 928
Type: Industrial
Sold Date: 03/07/2019
<https://www.gartland.com.au>

- * Land Area: 1981m2
- * Building Area: 540m2 approx
- * Showroom & Office
- * Good amenities
- * Wide street frontage

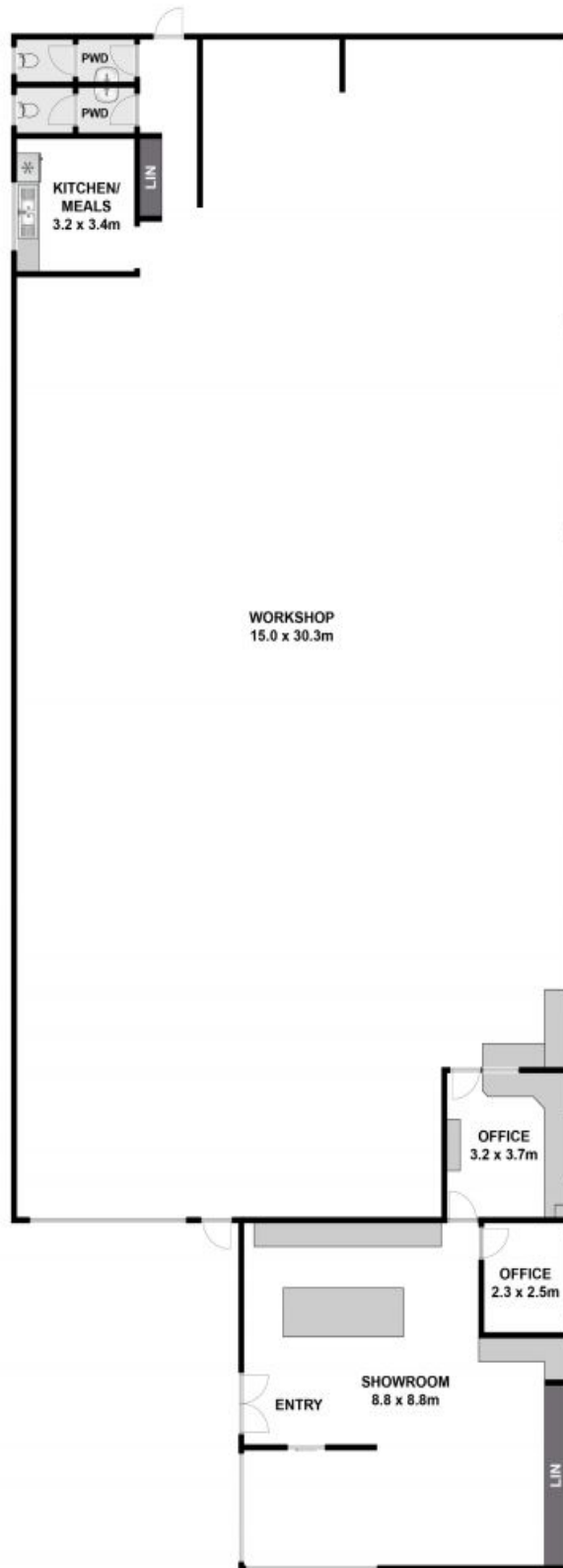

Approx House Area 541m²

While barrm.com.au has made every attempt to ensure the accuracy of the floor plan contained here, measurements are approximate and no responsibility is taken for any error, omission, or mis-statement. This plan is for illustrative purposes only.



25 Cowie Street, North Geelong

GARTLAND
PROPERTY

Plans shown are only indicative of layout. Dimensions are approximate.

North Geelong, VIC
25 Cowie Street