



Geelong, VIC

38 Myers Street

GARTLAND
PROPERTY

- * Up to 4 consulting rooms
- * Large reception/waiting area
- * Carpeted
- * Storage/computer room
- * Large tea room
- * Heating/Cooling
- * Rear parking for 4-5 cars
- * Floor area: 110m2 approx
- * Zoned: "Residential Growth Zone 1"
- * Available Now

\$32,900 + GST + Outgoings

Contact: Adam Farrell
0439 309 928

Type: Offices

Land: 180m2

<https://www.gartland.com.au>

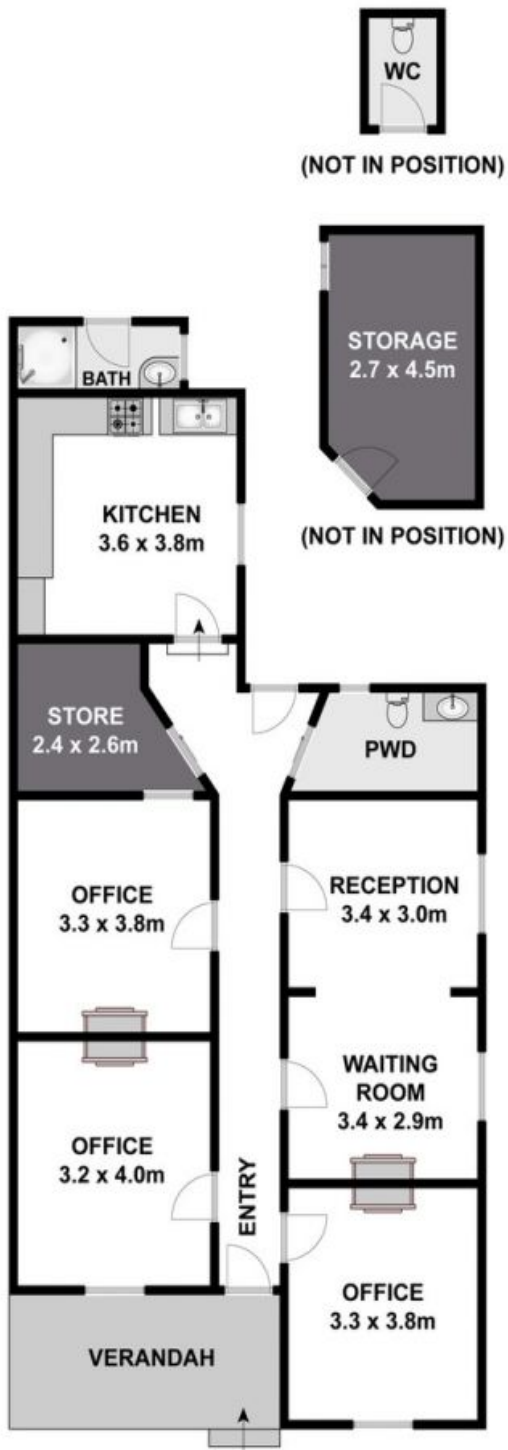

GROUND FLOOR

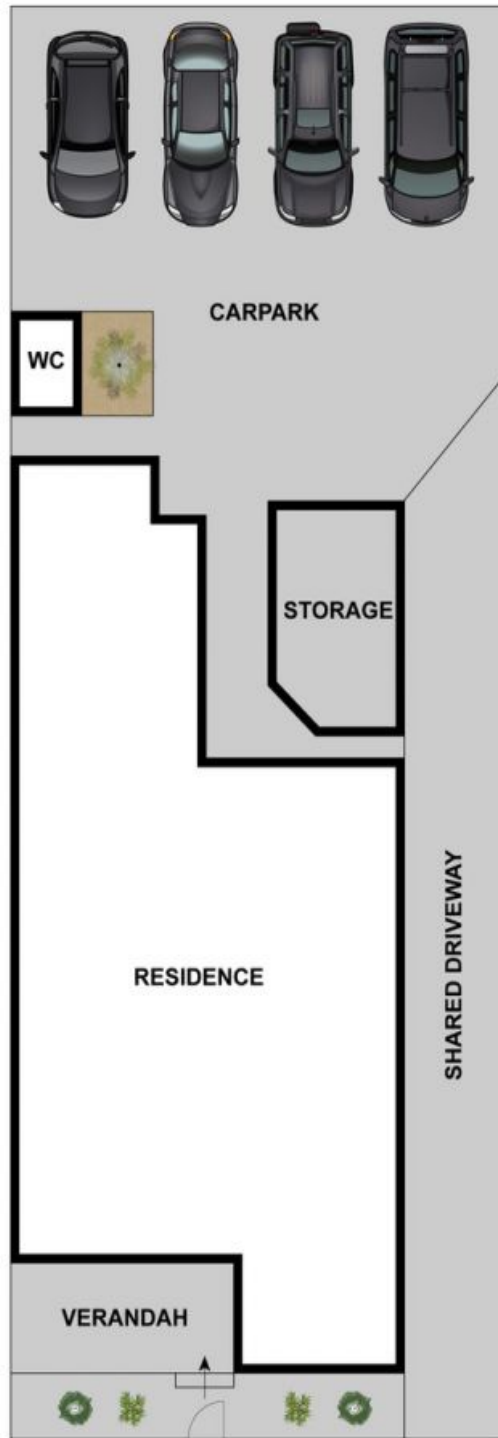

SITE PLAN

Approx House Area 110m²
 Approx Land Area 480m²

While bwm.com.au has made every attempt to ensure the accuracy of the floor plan contained here, measurements are approximate and no responsibility is taken for any error, omission, or mis-statement. This plan is for illustrative purposes only.



38 Myers Street, Geelong

GARTLAND
 PROPERTY

Plans shown are only indicative of layout. Dimensions are approximate.

Geelong, VIC
 38 Myers Street