



Charlemont, VIC

48 Deveraux Drive

3
BED

2
BATH

1
CAR

GARTLAND
PROPERTY

LEASED

Contact: Emily Reid
0411497783

Type: House

Date Available: 17/07/2020

Bond: \$1975

<https://www.gartland.com.au>

With two living areas, a rear undercover alfresco, and ducted heating and evaporative cooling throughout, this brand new home offers the complete package. With a brand new park nearby, this family friendly precinct allows a fantastic rural lifestyle without compromising on distance from all the essentials. This newly built property has neutral tones throughout, and offers three well sized bedrooms with built in robes - master with walk in robe and ensuite - a light and bright open plan living/meals and functional kitchen with dishwasher and feature window, second living/theatre space or home office, functional laundry, family bathroom with bath and shower and grassed rear yard, The single, remote entry garage has internal access and the yard is fully landscaped with an easy care garden, this property is ready to go, and won't last long.

- In order to protect the health and safety of all Gartland Property staff and clients, and in line with current COVID-19 (Coronavirus) updates, you may be asked to adhere to current social distancing recommendations when inspecting this property.

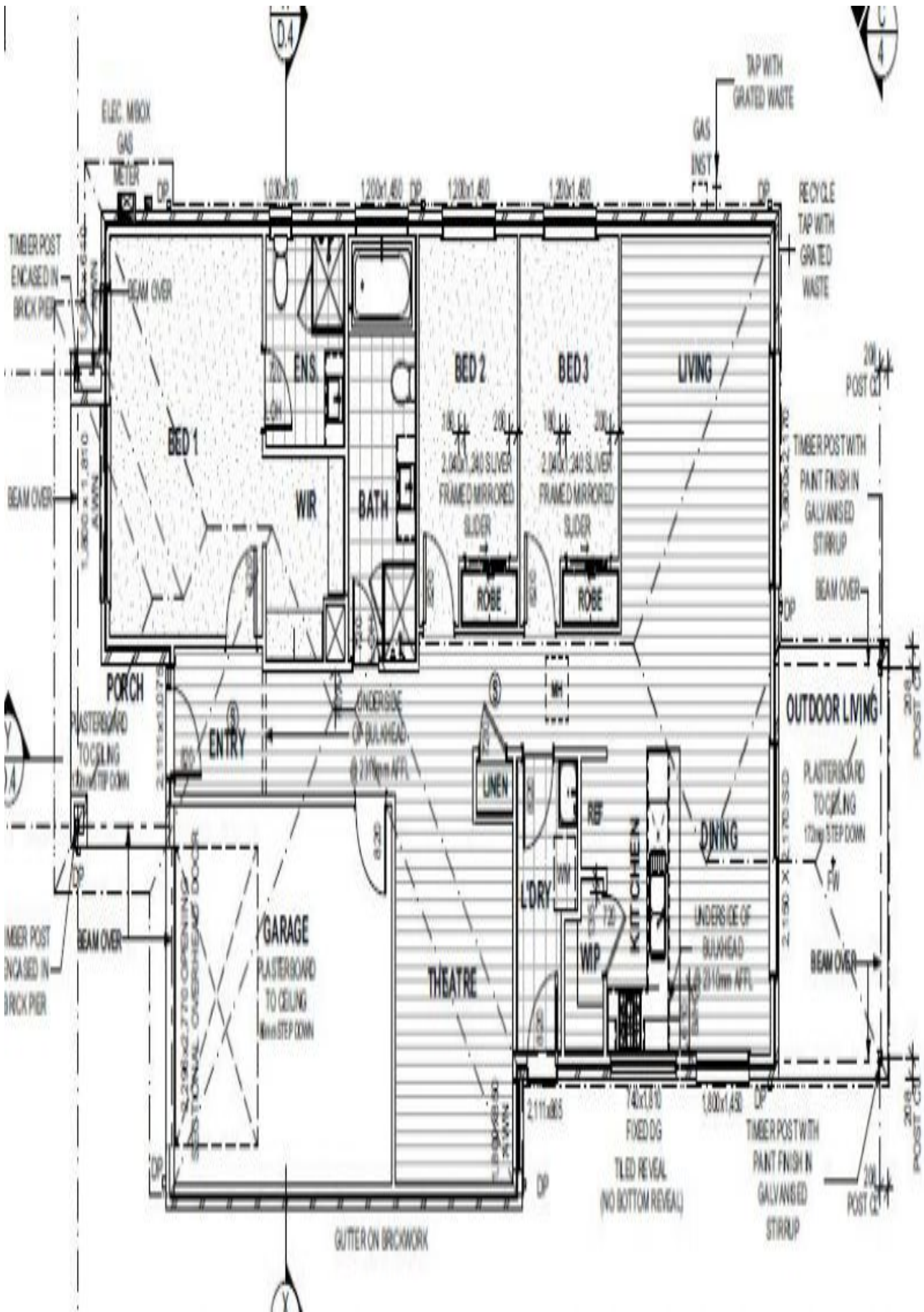

Plans shown are only indicative of layout. Dimensions are approximate.

Charlemont, VIC
48 Deveraux Drive